

## 5.0 Inch Small TFT LCD Display 720X1280 Industrial IPS LCD TFTscreen 8394F

Our Product Introduction

for more products please visit us on [tft-displaylcd.com](http://tft-displaylcd.com)

### Basic Information

- Place of Origin: Guangdong, China
- Certification: ROHS
- Model Number: T107HS500
- Minimum Order Quantity: 1
- Price: Negotiable
- Packaging Details: All the products are packed in right way to keep it safe. For small sizes of products we use tray+ carton, for bigger sizes we use foam slot+carton. We also design packages according to customers' requirements.
- Delivery Time: 7-10 workdays
- Payment Terms: T/T



### Product Specification

- Type: IPS
- Display Size: 5.0 Inch
- Supplier Type: LCD Panel
- Display & LCD Type: 720\* RGB \*1280
- Viewing Direction: All O'clock
- Interface Type: MIPI
- Touch Panel: Optional
- Outline Dimemsions (mm): 64.76\*118.7\*2.05 Mm
- Driver IC: 8394F
- Backlight Type: White LED
- PIN: 30
- Highlight: small tft lcd display 720x1280,  
5.0 inch small tft lcd display, small tft lcd panel



### More Images

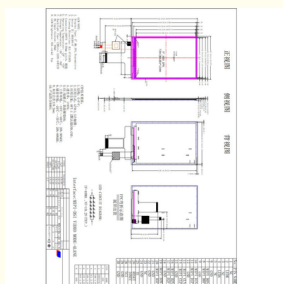

## Product Description

5.0 inch IPS TFT LCD Display 720\*1280 ips screen 8394F with/without Touch Panel for Industrial Needs

### Product Description

1.Display Type:	5.0 inch TFT LCD 8394F
2.Display mode:	Transmissive
3.Resolution:	5.0" 720*(RGB)*1280
4. Number of colors:	262K
5.Outline Dimensions:	64.76*118.7*2.05 mm
6.Driver IC:	8394F
7.Interface Type:	MIPI
8.Brightness	300
9.Operating voltage:	+2.8V~3.3V
10.Viewing Angle:	All O'clock
11.Operating Temp:	-20°C~+70°C
12.Storage Temp:	-30°C~+80°C





正视图

侧视图

背视图

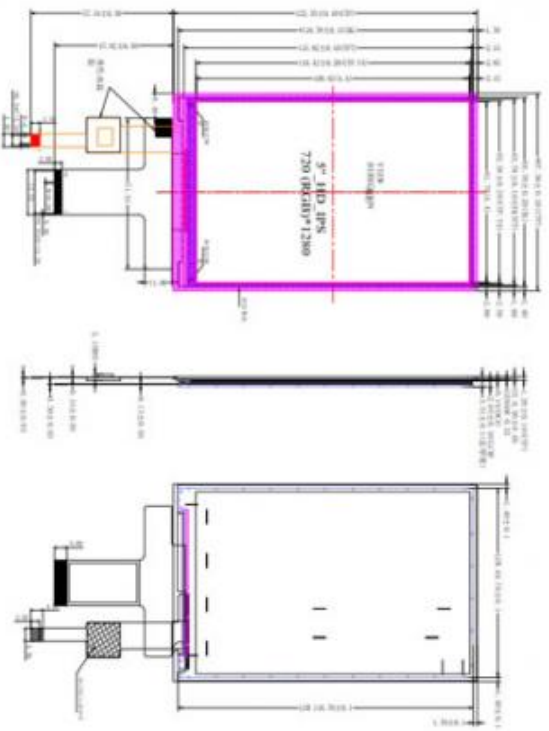

- LCM NOTE:
1. Display Type: 5" HD IPS, Transmissive
  2. Driver IC: B8201P
  3. Operating Voltage: 4.0V~5.5V
  4. Operating Current: 400mA
  5. Operating Temperature: -20°C ~ +70°C
  6. Storage Temperature: -30°C ~ +60°C
  7. Backlight Type: 1200lm LEDS 6串2并
  8. RL Input Current: 400mA
  9. LCM Brightness: 1000cd/m² Typ

- CTP技术要求:
1. 结构: G+T
  2. 应用方式: CT96 L 5.5线模组
  3. 应用方式: CT96 L 5.5线模组
  4. 透光率: ≥80%
  5. 对比度: ≥1000:1
  6. 工作电压: -10°C~+60°C, 20V~60VDC
  7. 工作电流: -20°C~+70°C, 20V~60VDC
  8. 储存环境: -30°C~+60°C, 20V~60VDC
  9. 备注: 公差±0.2mm
  10. 产品符合RoHS

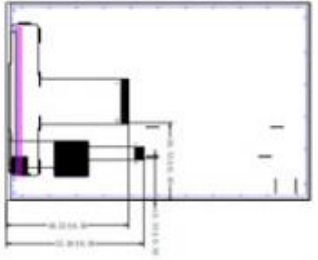

FPC弯折示意图  
展开出货

LED CIRCUIT DIAGRAM:  
IF=40MA, VF=19.2V (TYP.)

Interface: MIPI-DSI VIDEO MODE-4LANE

Pin	Signal	Pin	Signal	Pin	Signal	Pin	Signal
1	GND	17	MIPI D0N	33	GND	49	GND
2	MIPI D0N	18	GND	34	MIPI D1N	50	GND
3	MIPI D1N	19	MIPI D0N	35	GND	51	MIPI D1N
4	MIPI D1P	20	MIPI D1P	36	MIPI D1P	52	GND
5	GND	21	GND	37	MIPI D1P	53	GND
6	MIPI D0N	22	GND	38	GND	54	MIPI D0N
7	MIPI D0P	23	GND	39	GND	55	MIPI D0P
8	GND	24	GND	40	GND	56	GND
9	MIPI D1N	25	MIPI D1N	41	MIPI D1N	57	MIPI D1N
10	MIPI D1P	26	MIPI D1P	42	MIPI D1P	58	MIPI D1P
11	GND	27	MIPI D1P	43	GND	59	GND
12	MIPI D1P	28	GND	44	MIPI D1P	60	GND
13	MIPI D1N	29	GND	45	MIPI D1N	61	MIPI D1N
14	MIPI D1P	30	GND	46	MIPI D1P	62	MIPI D1P
15	GND	31	MIPI D1P	47	GND	63	GND
16	MIPI D1N	32	MIPI D1N	48	MIPI D1N	64	MIPI D1N

No.	PIN NAME
1	NC
2	LEDK
3	NC
4	LEDK
5	NC
6	GND
7	MIPI D0N
8	MIPI D0P
9	GND
10	MIPI D1N
11	MIPI D1P
12	GND
13	MIPI D1N
14	MIPI D1P
15	GND
16	MIPI D1N
17	MIPI D1P
18	GND
19	MIPI D0N
20	MIPI D0P
21	GND
22	GND
23	NC
24	GND
25	FE
26	RESET
27	IOVCC
28	VCC1
29	GND
30	GND

Pin	Signal
1	GND
2	MIPI D0N
3	MIPI D1N
4	MIPI D1P
5	GND
6	MIPI D0N
7	MIPI D0P
8	GND

## SHIPMENT



7-10 working days  
WWW.TNT.COM



5-7 working days  
WWW.EMS.COM.CN



5-7 working days  
WWW.DHL.COM



5-7 working days  
WWW.UPS.COM



5-7 working days  
WWW.FEDEX.COM



ESCROW

PayPal

T/T

L/C

## Our Services

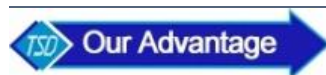

### why choose us

<p><b>PROFESSIONAL</b></p> <p>We have in the Production of razor supplies with 12 years of experiences</p>	<p><b>ONE-STOP</b></p> <p>We have our own factory, professional equipment to insure production</p>	<p><b>PRICE</b></p> <p>We will provide you the best price, it is the absolute value for money</p>	<p><b>OEM/ODM</b></p> <p>OEM/ODM orders are welcomed, we are trying to meet all your needs</p>	<p><b>SERVICE</b></p> <p>We have a comprehensive after-sales service with 24-hour service</p>
--	--	---	--	---

1. Replacement within 30 days after the shipment of products from us due to products' problems.
2. We can print your logo and stick your model No. on the cameras.
3. We have long cooperation with many shipping companies and our export volume is large. The shipping companies can offer us good discounts.
4. Professional technician supports. We have a good after-sales service team to solve your problems in time.
5. All goods will be inspected and tested before shipment.
6. Customer's satisfactory is most important to us. If you have any problem or questions regarding our transaction, please contact us by Trademanager or Email. It will be responded within 24 hours.

## Company Profile

ZhuoHong Electronic Technology has been specializing in TFT LCD display and touch screen more than 10 years. There are 90% of our business is custom made display modules for projects such as industrial devices, medical and smart home applications. Our mission is to provide customer one-stop solution. With LCD display and touch screen as our product center, great trust is built with our customers.





## FACTORY SHOW



COG Automatic Plant



Bonding IC



Rubberizing



Sample production



Assembling



QC testing

# APPLICATION



**SMART HOME**



**COMMERCIAL DISPLAY**



**POS TERMINA**



**MEDICAL DISPLAY**



**GATE MACHINE**



**AUTOMOTIVE DISPLA**



**INDUSTRIAL-DISPLAY**



**ROBOT**



**SELF SERVICE  
TERMINALS DISPLAY**

## FAQ

A Q: When can i get the quotation?

A: We usually quote within 12 hours after we got your inquiry.

If it is very urgent, please call us or contact us via email, Skype or WhatsApp.

Q: What is your warranty?

A: We provide one year warranty.

Q: May i buy samples from you?

A: Yes! You are welcome to place sample order to test our superior quality and service.

Q: How to place bulk order?

A: 1) Tell us model number, quantity, color and other special requirements.

2) Proforma Invoice will be made and sent to you for approval

3) Production will be arranged once get your payment or deposit.

4) Goods will be delivered as stated on the Proforma Invoice.

Q: How will you deliver my goods to me?

A: We provide as many shipping options as possible, such as DHL, UPS, FEDEX, TNT AND EMS to enable our customers get their goods rapidly at door. We also ship by economick method such as air cargo and sea cargo, direct line, air mail according to customers' request.

Q: What about the quality of your product?

A: We provide unrivald quality: very rigorous testing process for incoming quality control, input process quality control, and

final quantity control for every piece. We follow QC test procedure, and do 100% FQC to ensure your satisfaction.

Q: Can you provide OEM service?

A: Yes! We can provide professional OEM service.

Q: What payment method do you accept?

A: T/T(bank transfer), L/C and paypal

Q: Do you have any after-sales service?

A: Yes! Our product has professional after-sales service dept. Follow up R.M.A. Items service and upload product firmware and app for you download.

If you have any technical questions with the goods, please feel free to contact our technical support dept, or our sales directly.



**Shenzhen Zhuohong Electronic Technology Co., Ltd.**



13728899479



alice@zhuohongelectric.com



tft-displaylcd.com

Room 405, No. 1319-9, GuanGuang Road, XinLan Community, GuanLanStreet, LongHua District, 518110  
ShenZhen China